

SPECIAL CUT-OFF VALVES

ZOPo, ZOKo

Nominal diameter: 10 mm

Special cut-off valves ZOPo and ZOKo are used for manual draining of oil from cooling installations and equipment. These valves should be installed together with drain valve ZS-10.

Working parameters:

Working pressure: 25 bar, temperature range: - 40°C / +150°C.

Working medium: ammonia, freons, LPG, air and other non-aggressive media.

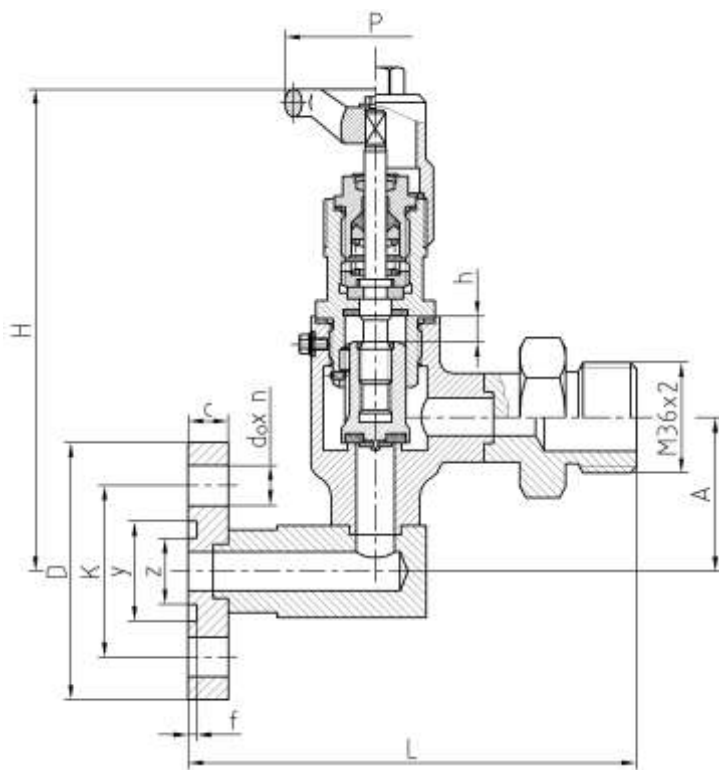

ZOPo

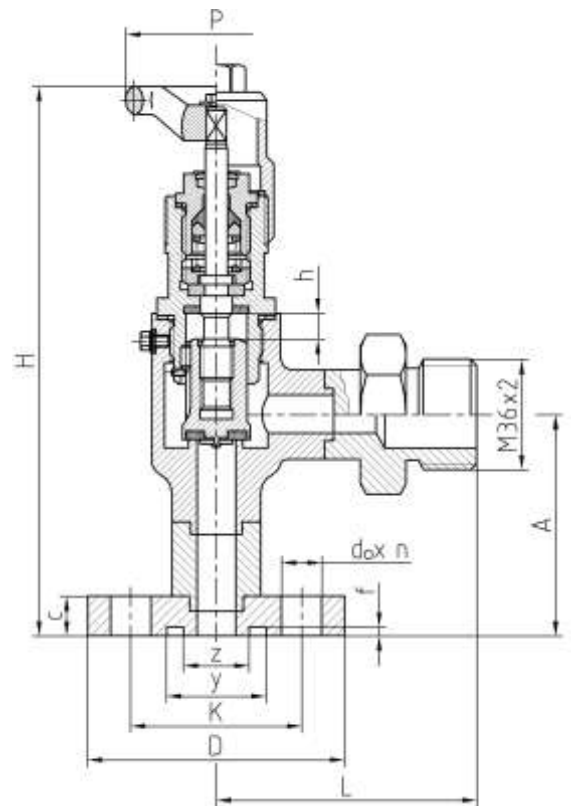

ZOKo

SPECIAL CUT-OFF VALVES – dimensions (mm)

Type and DN	L	H	A	h	P	D	K	y	z	f	c	d _o xn	Kvs m ³ /h	Weight kg
ZOPo 10	150	175	50	7,5	64	90	60	35	23	3	14	14x4	1,7	2,3
ZOKo 10	85	200	75	7,5	64	90	60	35	23	3	14	14x4	1,7	2,1